

## Receivership Sale

**BID DEADLINE DATE: August 22, 2012**

- ✓ Significant land position at McMullen and Wetaskiwin
- ✓ McMullen: Prospective for Wabiskaw heavy oil “cold production”
- ✓ McMullen: Develop area using “POD” drilling
- ✓ Wetaskiwin: Stable gas production

Bankers Hall, West Tower / 1000, 888 - 3rd Street SW / Calgary, Alberta T2P 5C5 / Phone: 403 444 5991



## Timing:

---

Review of Documents July 16, 2012 to August 21, 2012  
**Bid Deadline:** **August 22, 2012 4:00 p.m. MDT**  
Effective Date: August 1, 2012

## For further information contact:

---

**Mr. Arno A. Keller**, *President*  
Cell: 403 860 8692  
Email: [arno.keller@nrgdivestitures.com](mailto:arno.keller@nrgdivestitures.com)

**Mr. Steve Henrich**, *Managing Director*  
Cell: 403 874 7801  
Email: [steve.henrich@nrgdivestitures.com](mailto:steve.henrich@nrgdivestitures.com)

**Mr. Robbie Willmann**, *B.Sc., Geol.I.T. Geologist*  
Cell: 403 990 3791  
Email: [robbie.willmann@nrgdivestitures.com](mailto:robbie.willmann@nrgdivestitures.com)

## Marketed By:

---

**NRG Divestitures Inc.**  
**Bankers Hall, West Tower**  
1000, 888 - 3rd Street S.W.  
Calgary, Alberta T2P 5C5  
Phone: 403 444 5991  
Fax: 403 444 6699

[www.nrgdivestitures.com](http://www.nrgdivestitures.com)

## Disclaimer

---

*The marketing materials presented herein, reflect what is thought to be the current and accurate data, provided by the vendor. In the event that an inaccuracy is found, **F.T.I. Consulting Canada Inc.** or NRG Divestitures Inc. may not be held liable. Included in the marketing materials are statements based on interpretation and judgement. Anyone reviewing the marketing materials is encouraged to conduct their own investigations into the subject assets, in order to come to their own interpretations and conclusions, before proceeding. **F.T.I. Consulting Canada Inc.** reserves the right at it's sole discretion to accept or reject any or all offers, and may amend the offering at any time.*

## Executive Summary

---

NRG Divestitures has been retained by **FTI Consulting Inc.** (FTI) to assist in the receivership sale of the remaining McMullen and Wetaskiwin Alberta assets of **Trafina Energy Ltd.** (Trafina).

### **McMullen**

Trafina owns 100% working interest in 33 sections in the McMullen area of central Alberta. The area has considerable Wabiskaw heavy oil which Trafina has tested by drilling four vertical wells, and a program has commenced to further develop the area with a “pod” drilling approach. The successful vertical well pilot project was producing heavy oil at a rate of approximately 75 Bbls/d. Husky’s existing nine well pod directly to the north of Trafina’s lands have already yielded significant oil production, totalling 78,284 Bbls of oil since production began in May 2011, and produced at a rate of 251 Bbls/d in April 2012. All of Husky’s Wabiskaw pods in the area are producing in excess of 4,500 Bbls/d of oil as of April 2012. Trafina’s proved and probable reserves indicate 876 MBBL of recoverable oil.

### **Wetaskiwin**

Trafina also owns various interests in several sections in the Wetaskiwin field of east central Alberta. The wells in this field are primarily producing coal bed methane from the Horseshoe Canyon and Belly River Formations with an estimated 321 Mboe of proved and probable reserves.

**Trafina has approximately \$22 million in tax pools available for deduction into future years.**

Any asset sale will be completed on an “as is where is” basis and subject to approval of the Court.

---



**HIGHLIGHTS**

- ✓ 100% working interest
- ✓ 33 sections
- ✓ Wabiskaw heavy oil
- ✓ Adjacent Husky 9 well pod producing 251 Bbls/d.
- ✓ 2P reserves 876 Mbbl
- ✓ Completed all-weather access road with access to 7 leases.
- ✓ Licenses available to drill up to 32 slant wells.

**McMULLEN PROPERTY NET REVENUE SUMMARY**  
For the year 2011 and January - May 2012

	2011	2012 (Jan. - May)
<b>Gross Production</b>		
Oil Production (Bbl)	18,880	11,055
Gas Production (Mcf)	0	0
NGL Production (Bbl)	0	0
Total Production (Boe)	18,880	11,055
<b>Net Revenue Summary</b>		
Revenue (\$)	486,273	558,974
Royalty Expense (\$)	33,865	50,574
Operating Costs (\$)	457,779	514,415
Net Operating (Loss) (\$)	-5,371	-6,015

**Average Daily Production approximately 80 Boe/d**  
**For the Month of May 2012**

**McMULLEN LAND PLAT**

TRAFINA ENERGY LTD.

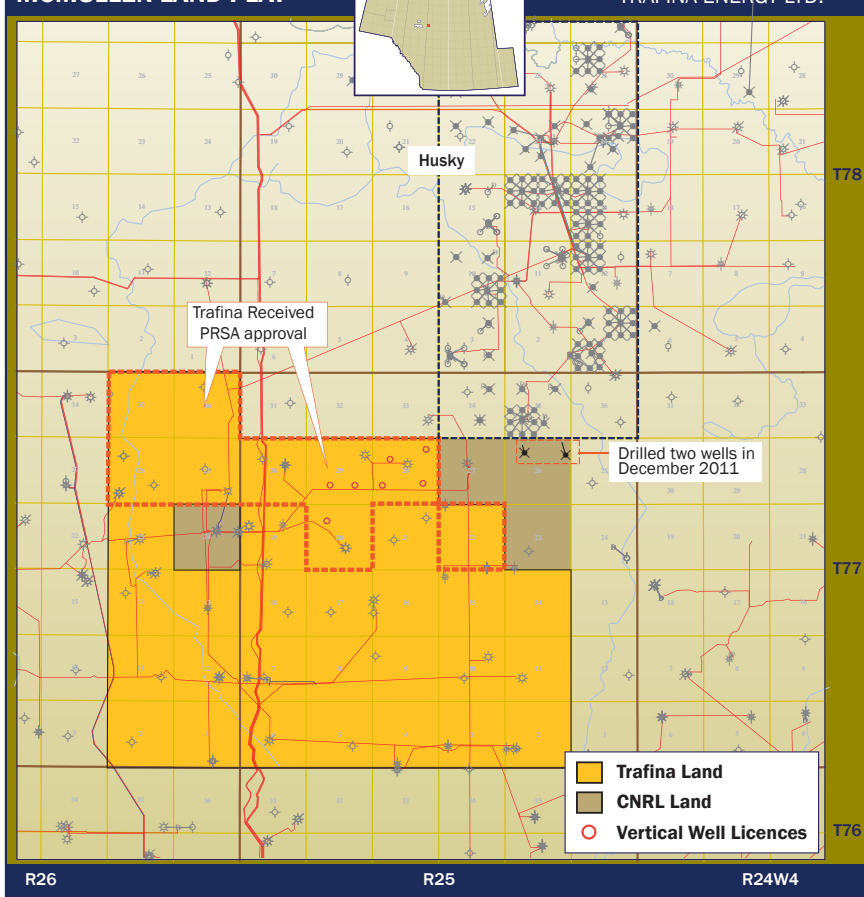

**McMULLEN LAND SUMMARY**

Twp-RgeM	Section	Rights	Gross Area (acres)	Lease Type	WI (%)
077-25W4	2, 3, 4, 5, 6, 7, 8, 9, 10, 11, 18	Oil Sands Below Top of Viking to Base Woodbend	11520	Crown	100
077-25W4	14, 15, 22	Oil Sands Below Top of Viking to Base Woodbend	1920	Crown	100
077-25W4	16, 17, 20, 21	Oil Sands Below Top of Viking to Base Woodbend	2560	Crown	100
077-25W4	19, 30	Oil Sands Below Top of Viking to Base Woodbend	3840	Crown	100
077-25W4	28	Oil Sands Below Top of Viking to Base Woodbend	640	Crown	100
077-25W4	29	Oil Sands Below Top of Viking to Base Woodbend	640	Crown	100
077-26W4	1, 2, 11, 12, 13, 14, 23	Oil Sands Below Top of Viking to Base Woodbend	11520	Crown	100
077-26W4	25, 26, 35, 36	Oil Sands Below Top of Viking to Base Woodbend	3840	Crown	100

**McMULLEN WELL SUMMARY**

Well Location	Zone	WI (%)	Operator	Status
05-28-077-25W4	Wabiskaw	100	Trafina	Shut - in
08-28-077-25W4	Wabiskaw	100	Trafina	Shut - in
11-28-077-25W4	Wabiskaw	100	Trafina	Suspended
16-28-077-25W4	Wabiskaw	100	Trafina	Shut - in
N-28-077-25W4	Wabiskaw	100	Trafina	N/A
S-28-077-25W4	Wabiskaw	100	Trafina	N/A

**McMULLEN PROPERTY RESERVES AND NET PRESENT VALUE - EFFECTIVE DECEMBER 31, 2011 (McDaniel Report)**

Property Reserves	Company Interest Reserves Before Royalties			NPV, \$000's Before Taxes		
	Oil (Mbbl)	NGL (Mbbl)	Gas (Mmcf)	5%	10%	15%
Total Proved	358	-	-	1,510.4	1,197.1	902.6
Total Proved Plus Probable	876	-	-	10,009.4	8,545.4	7,262.7

**Note:** Reserves and NPV are working interest before royalties  
NPV are calculated before taxes

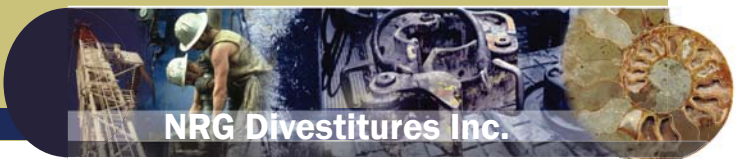

**McMULLEN OIL PRODUCTION**

TRAFINA ENERGY LTD.

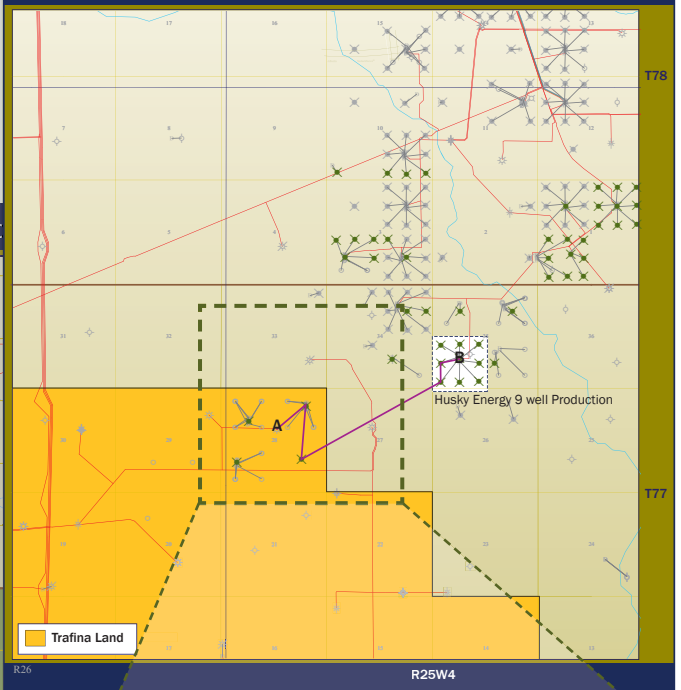

**McMULLEN AREA OPERATORS**

TRAFINA ENERGY LTD.

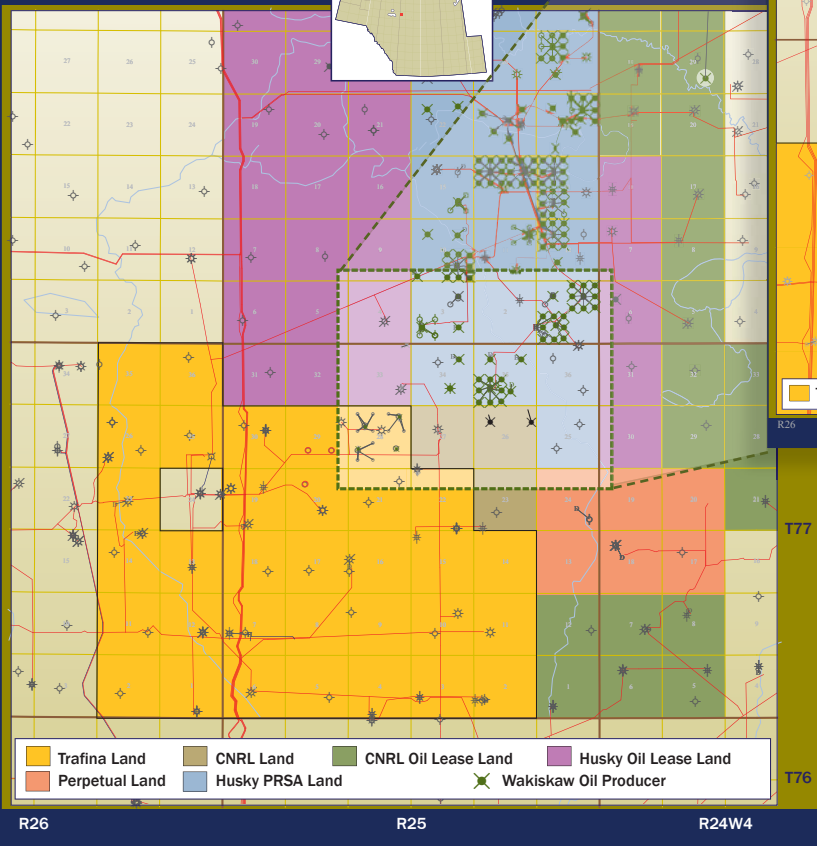

**McMULLEN NET PAY**

TRAFINA ENERGY LTD.

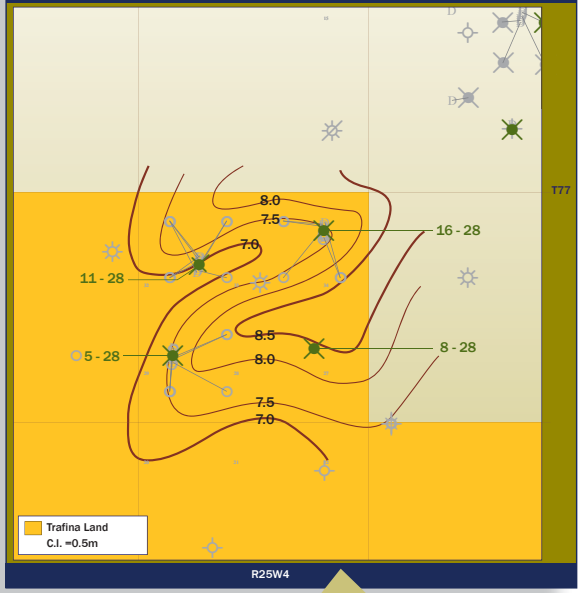

**Average Daily Oil Production (bbl/d)**

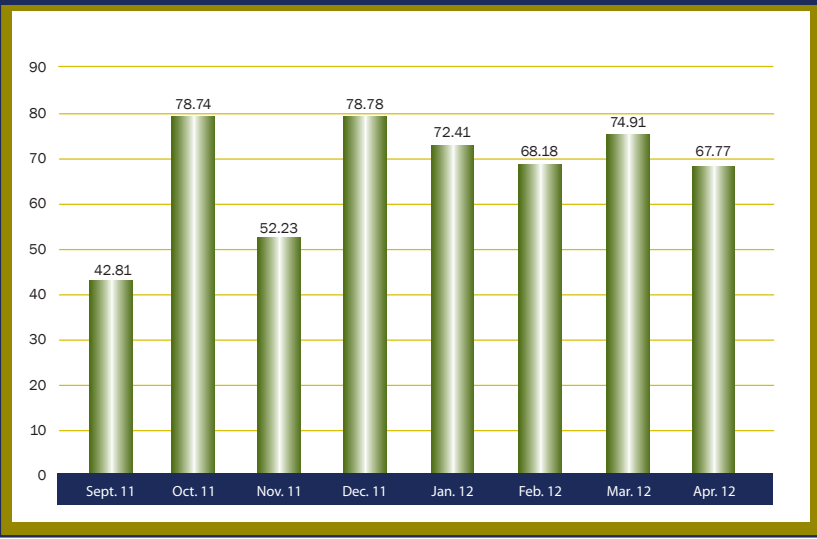

- ✓ Oil pay greater than 5 metres
- ✓ Pressure greater than 1,200 kPa
- ✓ Viscosity greater than 50,000 cP
- ✓ Calcite streak separating Wabiskaw A and Wabiskaw B.
- ✓ Oil streak in Wabasca B
- ✓ 90% of McMullen reserves are located in section 28 based on the results of drilling four vertical wells.
- ✓ Remaining 10% of McMullen reserves are based on three additional wells to be drilled in adjacent sections.

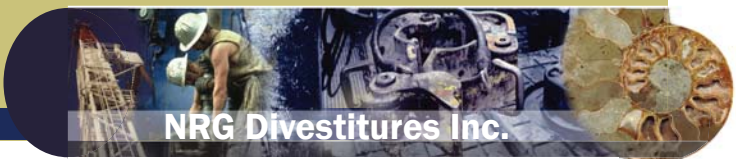

**MCMULLEN CROSS SECTION**

TRAFINA ENERGY LTD.

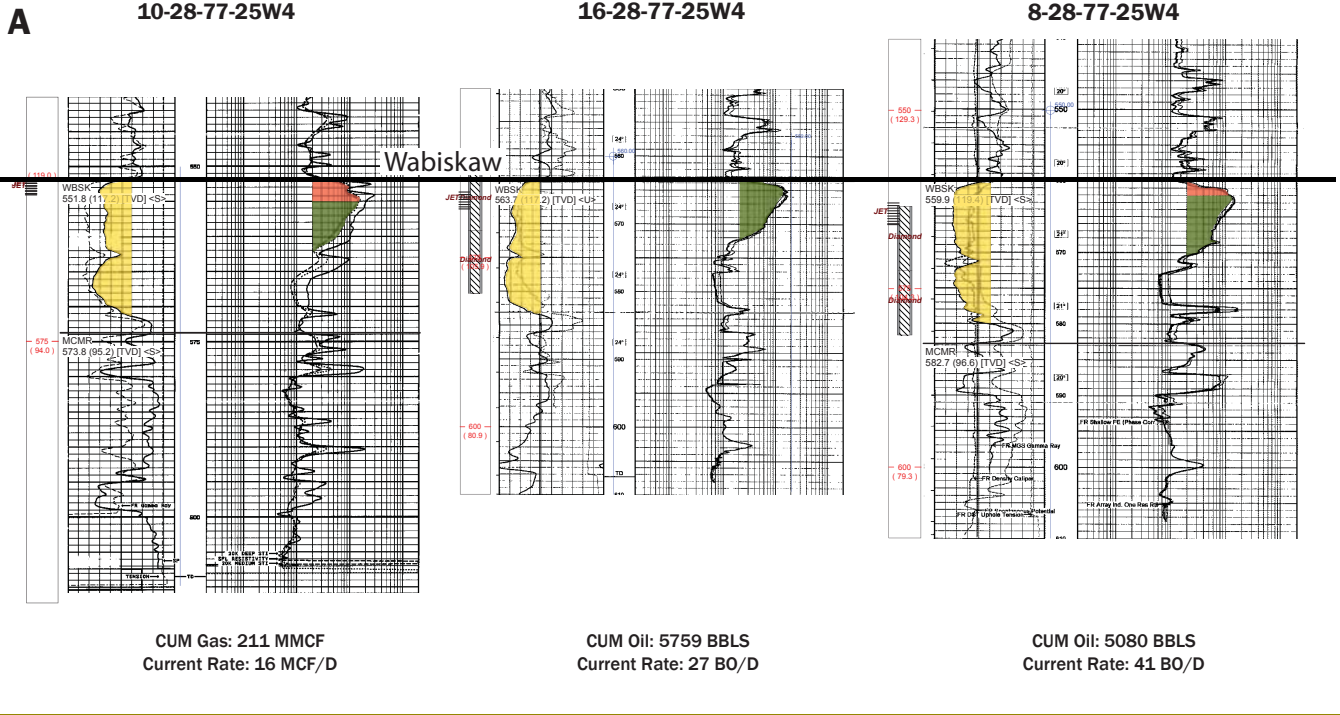

**MCMULLEN CROSS SECTION**

TRAFINA ENERGY LTD.

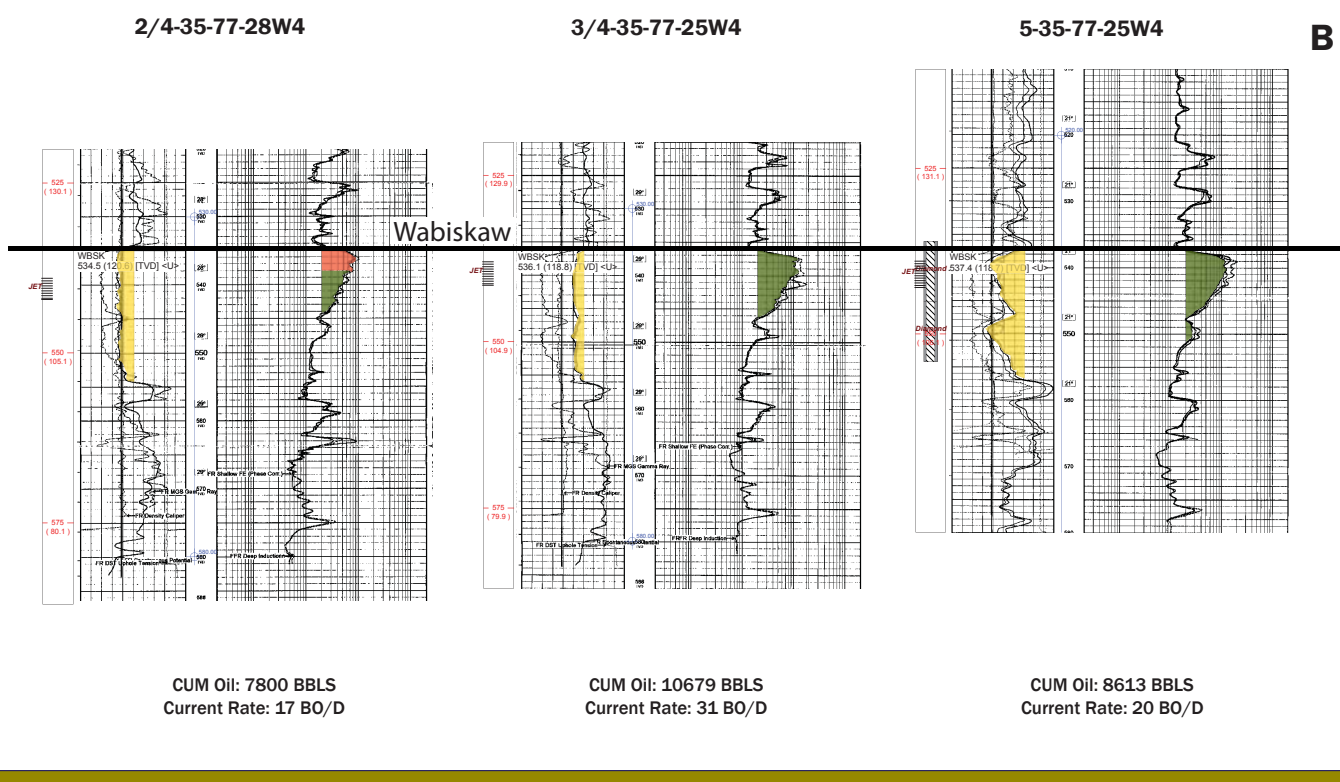

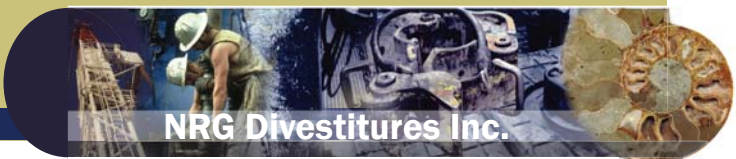

**HIGHLIGHTS**

- ✓ Various interests in several sections
- ✓ CBM from Edmonton Group Horseshoe Canyon and Belly River
- ✓ Gas in place for only the dry Edmonton coal seam has been estimated at 1.1 Bcf on a quarter section basis.
- ✓ 2P reserves of 321 Mboe in 2011.
- ✓ Total proved reserves in 2010 were valued at \$1.74 MM @ 15%.

**WETASKIWIN LAND PLAT**

TRAFINA ENERGY LTD.

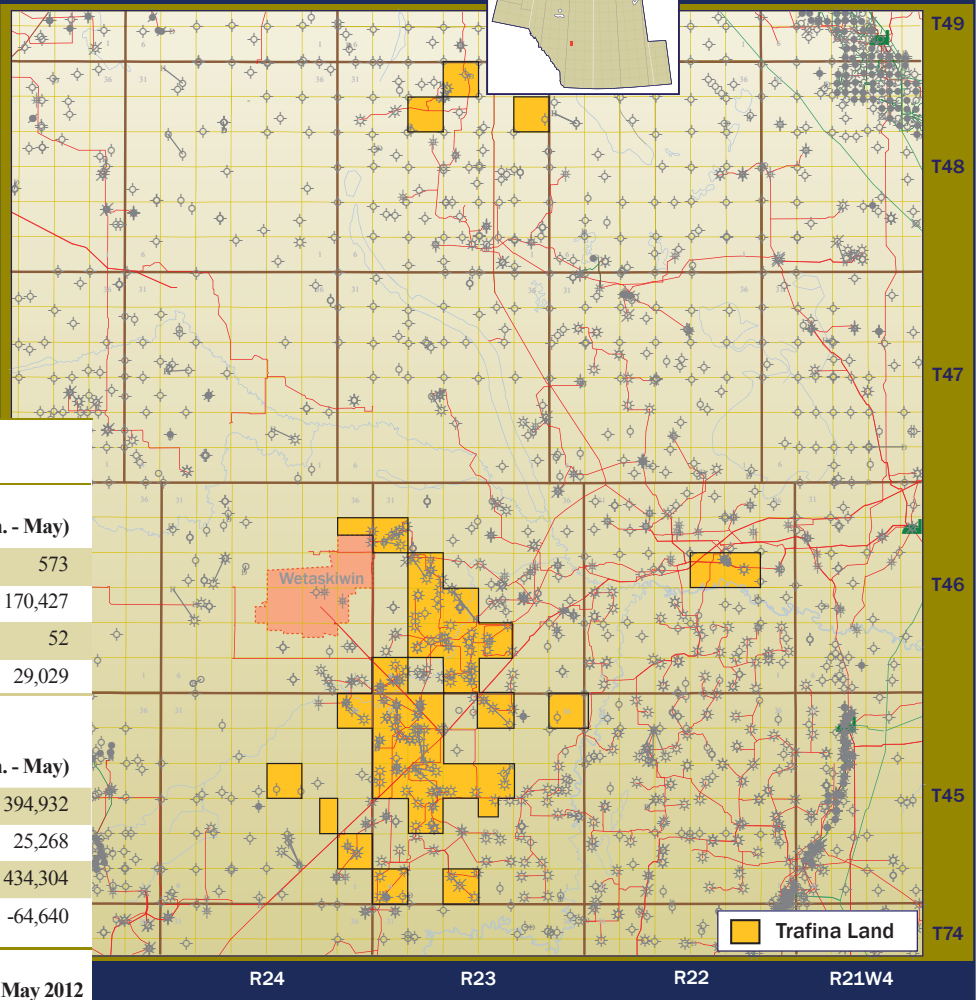

**WETASKIWIN PROPERTY NET REVENUE SUMMARY**  
For the year 2011 and January - May 2012

Gross Production	2011	2012 (Jan. - May)
Oil Production (Bbl)	3,506	573
Gas Production (Mcf)	470,033	170,427
NGL Production (Bbl)	328	52
Total Production (Boe)	82,173	29,029

Net Revenue Summary	2011	2012 (Jan. - May)
Revenue (\$)	2,007,792	394,932
Royalty Expense (\$)	187,113	25,268
Operating Costs (\$)	1,365,097	434,304
Net Operating Income (loss) (\$)	455,583	-64,640

Average Daily Production 160 Boe/d For the Month of May 2012

**WETASKIWIN HSC CBM RESERVE STATUS**

TRAFINA ENERGY LTD.

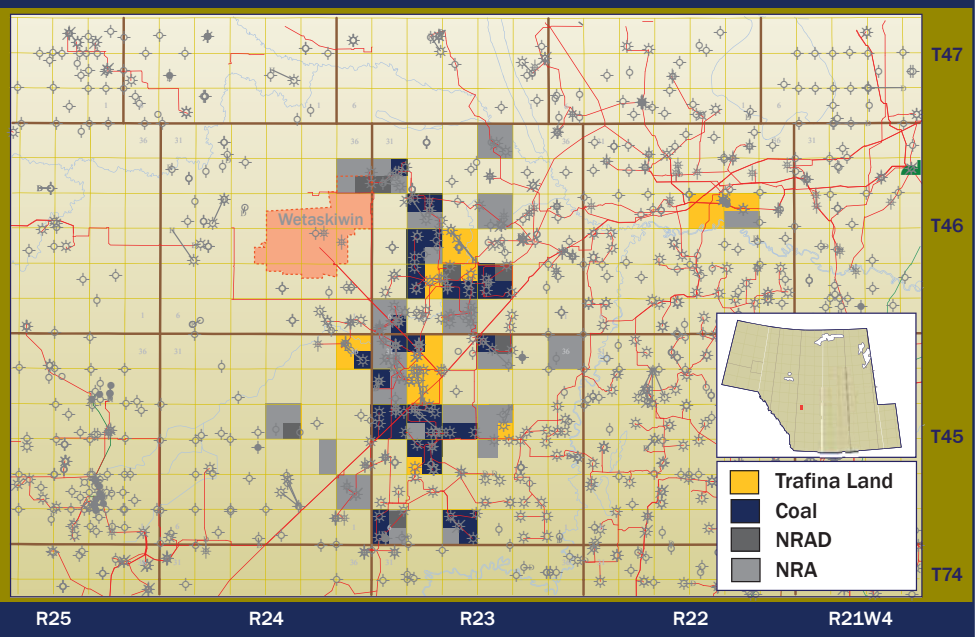

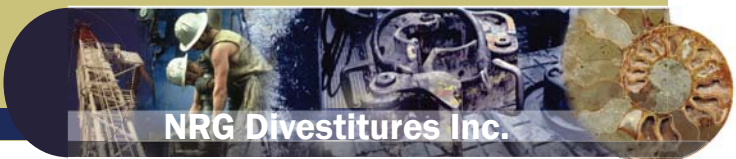

**WETASKIWIN\* LAND SUMMARY**

Twp-RgeM	Section	Rights	Gross Area (acres)	Lease Type	WI (%)
045-23W4	4	Various Rights	640	Crown	Various Interests
045-23W4	6 (SE)	Various Rights	160	Crown	Various Interests
045-23W4	6 (SW)	Various Rights	160	Crown	Various Interests
045-23W4	6 (NE)	PNG to Base Edmonton	160	Crown	40
045-23W4	6 (NW)	PNG from Surface to Base of Edmonton Group	160	Crown	40
045-23W4	15 (NW)	All PNG Excl. Coal	161	Crown	100
045-23W4	17 (LSD 1, 2)	Various Rights	80	Freehold	Various Interests
045-23W4	17 (SW)	Various Rights	160	Freehold	Various Interests
045-23W4	17 (LSD 7, 8)	Various Rights	80	Freehold	Various Interests
045-23W4	17 (NE)	Various Rights	160	Freehold	Various Interests
045-23W4	17 (NW)	Various Rights	160	Freehold	Various Interests
045-23W4	19 (SE)	Various Rights	160	Freehold	Various Interests
045-23W4	19 (SW)	Various Rights	160	Freehold	Various Interests
045-23W4	19 (NE)	Various Rights	160	Freehold	Various Interests
045-23W4	19 (NW)	Various Rights	160	Freehold	Various Interests
045-23W4	20	Various Rights	640	Crown	Various Interests
045-23W4	21 (LSD 1, 2)	CBM in Horseshoe Canyon	80	Freehold	10
045-23W4	21 (SW)	CBM in Horseshoe Canyon	160	Freehold	10
045-23W4	21 (LSD 7, 8)	CBM in Horseshoe Canyon	80	Freehold	10
045-23W4	21 (NE)	CBM in Horseshoe Canyon	160	Freehold	10
045-23W4	21 (NW)	Various Rights	160	Freehold	Various Interests
045-23W4	22	PNG to Base Edmonton	640	Crown	16
045-23W4	29	PNG in Upper Mannville	640	Crown	100
045-23W4	30	PNG to Base Belly River	640	Crown	100
045-23W4	31 (SE)	Various Rights	160	Crown	Various Interests
045-23W4	31 (SW)	PNG Excl. Coal and Valuable Stones	160	Freehold	100
045-23W4	31 (NE)	Various Rights	160	Freehold	Various Interests
045-23W4	31 (NW)	Various Rights	160	Freehold	Various Interests
045-23W4	34	Various Rights	640	Crown	Various Interests
045-23W4	36	Various Rights	640	Crown	Various Interests
045-24W4	12 (E)	Various Rights	320	Crown	Various Interests
045-24W4	12 (W)	Various Rights	320	Crown	Various Interests
045-24W4	14 (E)	PNG to Base Mannville	320	Crown	50
045-24W4	22	Various Rights	640	Crown	Various Interests
045-24W4	36	Various Rights	640	Crown	Various Interests
046-23W4	6	PNG to Base Mannville	640	Crown	100

\* Full rights and interests available upon signing of a CA.

**WETASKIWIN WELL SUMMARY**

Well Location	Zone	WI (%) / Operator	Status
00/15-17-045-23W4/02	Horseshoe Canyon	40.00% Nexen	Flowing CBM
00/14-31-045-23W4/2	N/A	100.00% Trafina	Abandoned
00/14-17-046-23W4	N/A	40.00% Nexen	Standing
00/10-20-046-23W4/00 & 03	Horseshoe Canyon	50.00% Nexen	Flowing CBM
00/01-20-045-23W4/0	Belly River	40.00% Nexen	Suspended CBM
00/10-31-045-23W4/5	N/A	100.00% Trafina	Suspended Gas
00/13-34-045-23W4	Horseshoe Canyon	40.00% Nexen	Pumping CBM
00/05-04-046-23W4	Horseshoe Canyon	40.00% Nexen	Pumping CBM
00/08-04-046-23W4	Horseshoe Canyon	40.00% Nexen	Suspended CBM
02/09-04-046-23W4	Horseshoe Canyon	40.00% Nexen	Suspended CBM
02/12-04-046-23W4	Horseshoe Canyon	40.00% Nexen	Standing
00/08-06-046-23W4/3	Belly River	100.00% Trafina	Abandoned CBM
00/05-09-046-23W4	Belly River	50.50% Nexen	Abandoned Gas
02/12-09-046-23W4	Horseshoe Canyon	50.50% Nexen	Abandoned CBM
02/10-30-046-23W4	Belly River	40.00% Nexen	Flowing CBM
00/09-25-046-24W4/0	Horseshoe Canyon	40.00% Nexen	Suspended CBM
12-10-046-23W4	Edmonton	60.00% Nexen	Pumping CBM
02/04-06-046-23W4/2	Belly River	100.00% Trafina	Suspended Gas
02/07-06-046-23W4/0	Belly River	100.00% Trafina	Flowing Gas
00/13-06-045-23W4	Horseshoe Canyon	40.00% Nexen	Flowing CBM
00/04-06-045-23W4	Horseshoe Canyon	40.00% Nexen	Flowing CBM
00/13-04-045-23W4	Horseshoe Canyon	16.00% Nexen	Pumping CBM
00/01-09-046-23W4	Horseshoe Canyon	50.50% Nexen	Pumping CBM
00/09-09-046-23W4	Horseshoe Canyon	50.50% Nexen	Pumping CBM
00/13-09-046-23W4	Horseshoe Canyon	50.50% Nexen	Suspended CBM
00/09-08-046-23W4	Horseshoe Canyon	40.00% Nexen	Suspended CBM
00/13-08-046-23W4	Horseshoe Canyon	40.00% Nexen	Pumping CBM
00/01-20-046-23W4	Horseshoe Canyon	50.00% Nexen	Pumping CBM
00/13-20-046-23W4	Horseshoe Canyon	50.00% Nexen	Pumping CBM
02/16-30-046-23W4	Horseshoe Canyon	40.00% Nexen	Pumping CBM
00/06-30-046-23W4	N/A	40.00% Nexen	Standing
00/01-10-046-23W4	Horseshoe Canyon	60.00% Nexen	Pumping CBM
00/04-10-046-23W4	Horseshoe Canyon	36.00% Nexen	Pumping CBM
00/16-10-046-23W4	Horseshoe Canyon	36.00% Nexen	Pumping CBM
00/09-34-045-23W4	Horseshoe Canyon	40.00% Nexen	Pumping CBM
00/13-20-045-23W4	Horseshoe Canyon	40.00% Nexen	Pumping CBM
00/02-20-045-23W4	Horseshoe Canyon	40.00% Nexen	Pumping CBM
00/16-04-045-23W4	Horseshoe Canyon	16.00% Nexen	Pumping CBM
01-22-045-24 W4M	Belly River	23.00% Nexen	Standing



## WETASKIWIN WELL SUMMARY

Well Location	Zone	WI (%) / Operator	Status
01-04-045-23 W4M	Belly River	10.57% Nexen	Pumping CBM
16-06-045-23 W4M	Belly River	40.00% Nexen	Suspended CBM
04-17-045-23 W4M	Belly River	35.00% Nexen	Flowing CBM
04-21-045-23 W4M	Belly River	10.00% Nexen	Flowing CBM
01-21-045-23 W4M	Belly River	10.00% Nexen	Flowing CBM
15-20-045-23 W4M	Belly River	40.00% Nexen	Flowing CBM
02/15-19-045-23 W4M	Belly River	25.00% Nexen	Flowing CBM
13-19-045-23 W4M	Belly River	25.00% Nexen	Flowing CBM
16-17-046-23 W4M	Belly River	35.00% Nexen	Flowing CBM
04-17-046-23 W4M	Horseshoe Canyon	35.00% Nexen	Flowing CBM
08-25-046-24 W4M	Horseshoe Canyon	40.00% Nexen	Suspended CBM
05-08-046-23 W4M	Belly River	40.00% Nexen	Suspended CBM
00/11-04-045-23W4/0	Ellerslie	16.00% Nexen	Suspended Gas
00/02-17-045-23W4	Ellerslie	40.00% Nexen	Suspended Gas
15-19-045-23 W4M	Cummings	25.00% Nexen	Abandoned Gas
00/12-29-045-23W4/2	Glauconitic	100.00% Trafina	Suspended Water Disposal
00/12-30-045-23W4/0	Glauconitic	37.50% CNRL	Abandoned Gas
00/16-30-045-23W4/3	Glauconitic	37.50% Trafina	Abandoned CBM
00/02-31-045-23W4/0	Belly River	100.00% Trafina	Flowing Gas
00/06-31-045-23W4/0	Glauconitic	100.00% Trafina	Suspended Gas
00/07-31-045-23W4/2	Wabamun	100.00% Trafina	Standing
00/06-32-045-23W4	Ellerslie	37.50% CNRL	Suspended Gas
00/11-32-045-23W4	Mannville	37.50% CNRL	Abandoned
00/05-36-045-23W4/0	N/A	60.00% Nexen	Standing
00/06-22-045-24W4	Wabamun	23.00% Nexen	Standing
00/16-22-046-22W4	Ellerslie	71.43% Trafina	Suspended Oil
02/04-06-046-23W4	Belly River	100.00% Trafina	Suspended Gas
02/04-06-046-23W4/2	Horseshoe Canyon	100.00% Trafina	Suspended Gas
00/07-06-046-23W4/0	Belly River	100.00% Trafina	Flowing Gas
00/09-06-046-23W4	Ellerslie	100.00% Trafina	Flowing Gas
00/15-06-046-23W4/0	Belly River	100.00% Trafina	Flowing Gas
00/07-08-046-23W4/0	Glauconitic	100.00% Trafina	Suspended Gas
00/07-09-046-23W4/0	Ellerslie	100.00% Trafina	Flowing Gas
02/04-34-048-23W4/0	Milk River, Ellerslie	50.00% Rife	Suspended Gas
00/03-06-045-23W4/03	Glauconitic	100.00% Trafina	Suspended Oil
00/12-23-046-22W4/0	Ellerslie	50.00% Trafina	Flowing Oil

## WETASKIWIN PROPERTY RESERVES AND NET PRESENT VALUE - EFFECTIVE DECEMBER 31, 2011 (McDaniel Report)

Property Reserves	Company Interest Reserves Before Royalties				NPV, \$000's Before Taxes		
	Oil (Mbbbl)	NGL (Mbbbl)	Gas (Mmcf)	Total (Mboe)	5%	10%	15%
Total Proved	8.9	0.8	1106.4	193.3	-18.1	85.8	153.3
Total Proved Plus Probable	12.1	2.5	1854.7	321.2	1122.6	1059.9	991.6

**Note:** Reserves and NPV are working interest before royalties  
NPV are calculated before taxes



<b>Table of Contents:</b>	<b>Page</b>
Provost	1
Bittern Lake / Wizard Lake / Woodbend	2
Lone Pine Creek	3
Pine Creek	3
Riviere	3
Heathdale	3
Alford Creek	4
Three Hills	4
Shekille	4
Alexis	4
Bellis	5
Giroux Lake	5
Grande Prairie	5
House Mountain	5
knopcik	6
Saddle Hills	6
Utikuma	6
Waskahigan	7
Windfall	7
Meekwap	7
Farrow	7
Peerless	8
Harronton	8
Twin Lake	8
Swan Hills	8
Restoration Costs	9



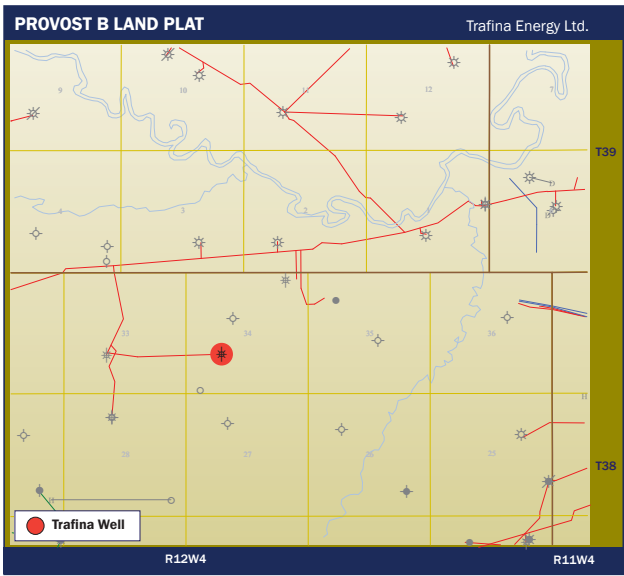
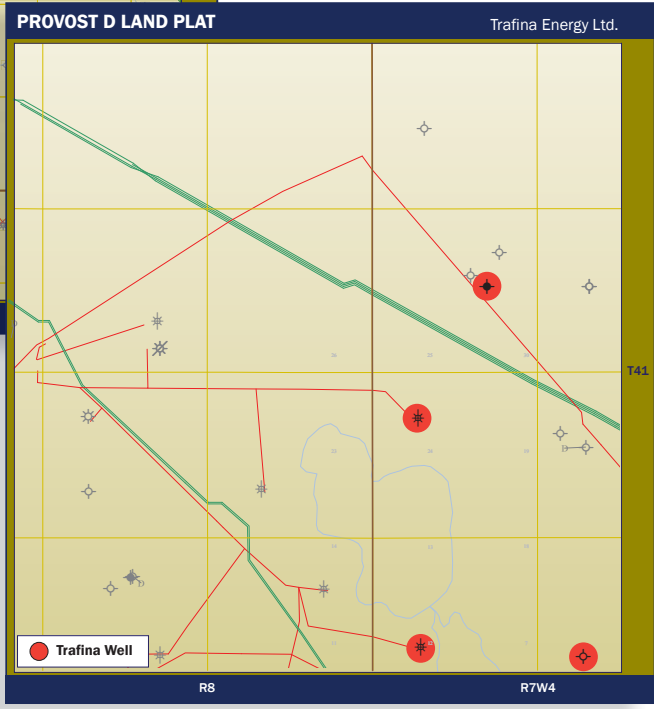
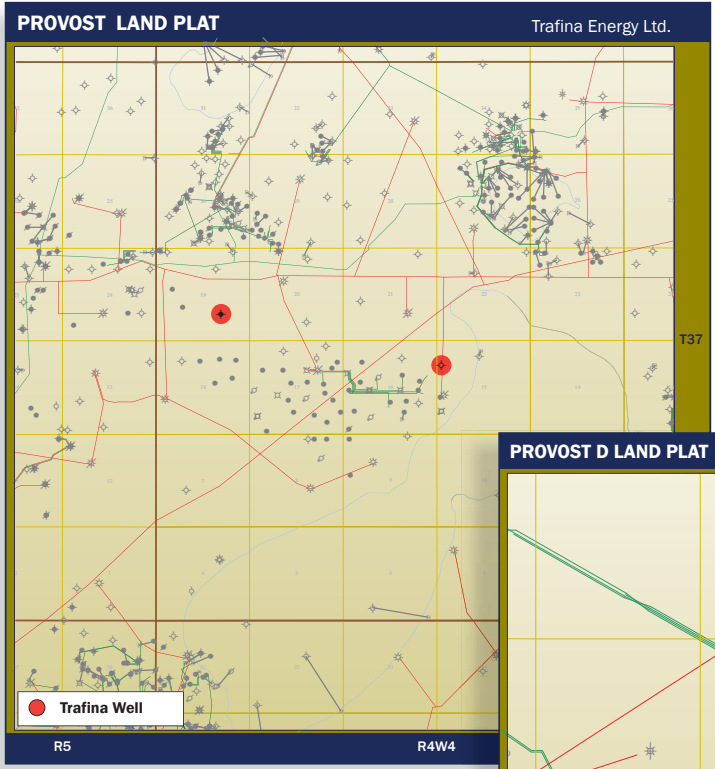
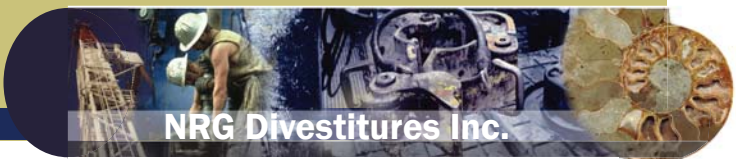

**WELL SUMMARY**

Well Location	Zone	WI (%)	Operator	Status	Field
100/06-07-041-07W4/00	Viking	14.25%	Avenex	Abandoned Gas	Provost
100/11-18-041-07W4/00	Viking	14.25%	Avenex	Abandoned Gas	Provost
100/12-15-037-04W4/00	Nisku	1.13%	Avenex	Abandoned	Provost
100/07-19-037-04W4/00	Ellerslie	3.30%	Avenex	Abandoned Oil	Provost
100/06-34-038-12W4/00	Viking	14.25%	Avenex	Abandoned Gas	Provost
100/11-06-041-07W4/00	Viking	14.25%	Avenex	Abandoned Gas	Provost
100/09-19-041-07W4/00	Paleozoic	14.25%	Avenex	Abandoned	Provost



# BITTERN LAKE / WIZARD LAKE LAND PLAT

Trafina Energy Ltd.

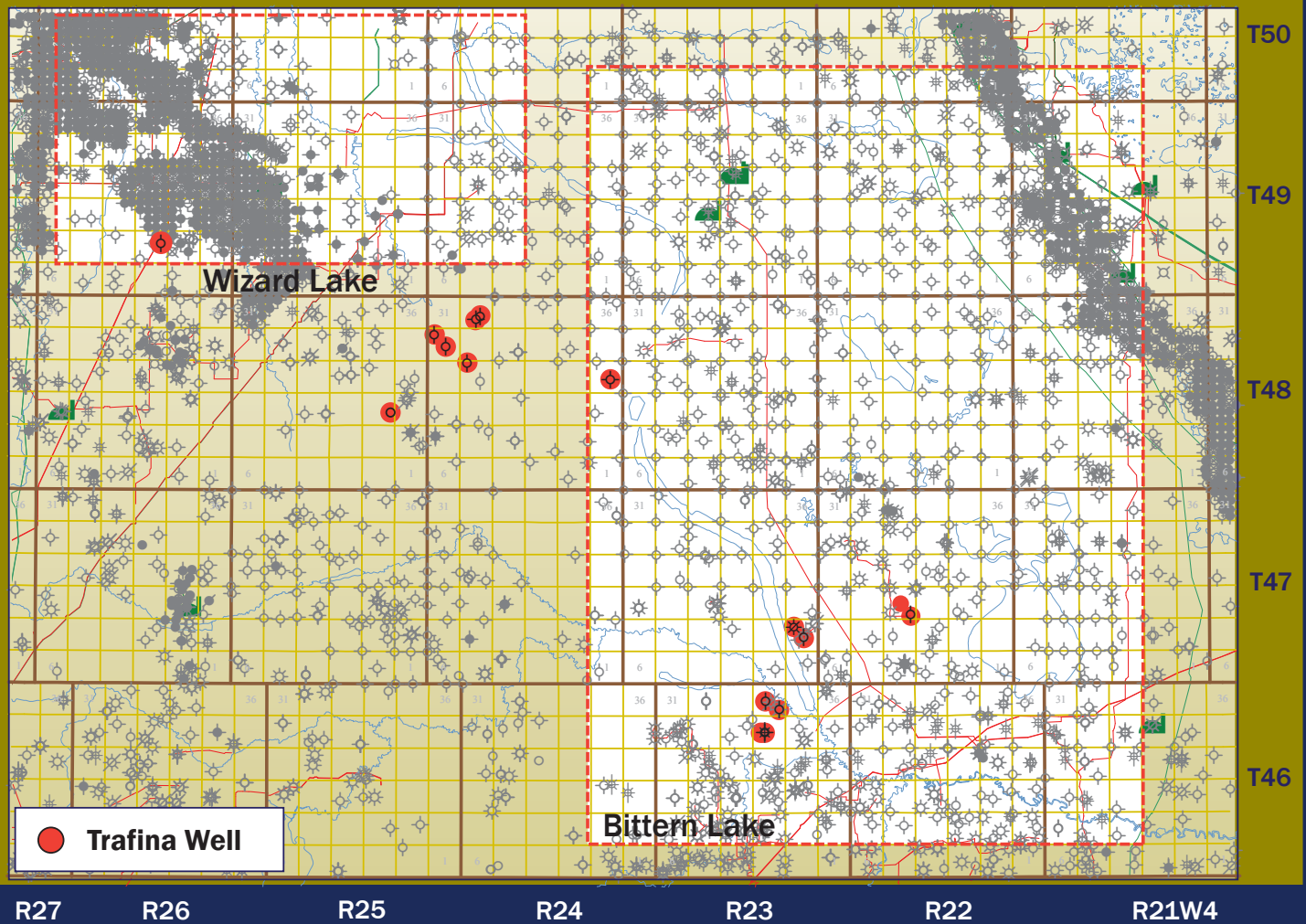

### WELL SUMMARY

Well Location	Zone	WI (%)	Operator	Status	Field
100/06-22-046-23W4/00	No Data	50.00%	No Data	No Data	Bittern Lake
100/07-22-046-23W4/00	Ellerslie	50.00%	CNRL	Abandoned Gas	Bittern Lake
100/01-34-046-23W4/00	Ellerslie	50.00%	Trafina	Suspended CBM	Bittern Lake
100/06-34-046-23W4/00	Belly River	50.00%	Trafina	Standing	Bittern Lake
100/01-16-047-23W4/00	Ellerslie	50.00%	Trafina	Suspended CBM	Bittern Lake
100/07-16-047-23W4/00	Belly River	50.00%	Trafina	Standing	Bittern Lake
100/07-12-047-23W4/00	Belly River	50.00%	Trafina	Standing	Bittern Lake
100/12-12-047-23W4/00	Ellerslie	50.00%	Trafina	Suspended Gas	Bittern Lake
100/07-20-048-24W4/00	Mannville	50.00%	Sedna	Standing	Wizard Lake / Leduc Woodbend
100/13-20-048-24W4/00	Edmonton	50.00%	Sedna	Standing	Wizard Lake / Leduc Woodbend
100/07-32-048-24W4/00	Mannville	50.00%	Sedna	Standing	Wizard Lake / Leduc Woodbend
100/07-24-048-24W4/00	No Data	50.00%	No Data	No Data	Wizard Lake / Leduc Woodbend
100/07-30-048-24W4/00	No Data	50.00%	No Data	No Data	Wizard Lake / Leduc Woodbend
100/13-30-048-24W4/00	No Data	50.00%	No Data	No Data	Wizard Lake / Leduc Woodbend
100/09-10-049-26W4/00	Horseshoe Canyon	50.00%	Sedna	Standing	Wizard Lake / Leduc Woodbend
102/09-32-048-27W4/00	Horseshoe Canyon	50.00%	Sedna	Standing	Wizard Lake / Leduc Woodbend
100/08-14-048-25W4/00	No Data	50.00%	No Data	No Data	Wizard Lake / Leduc Woodbend

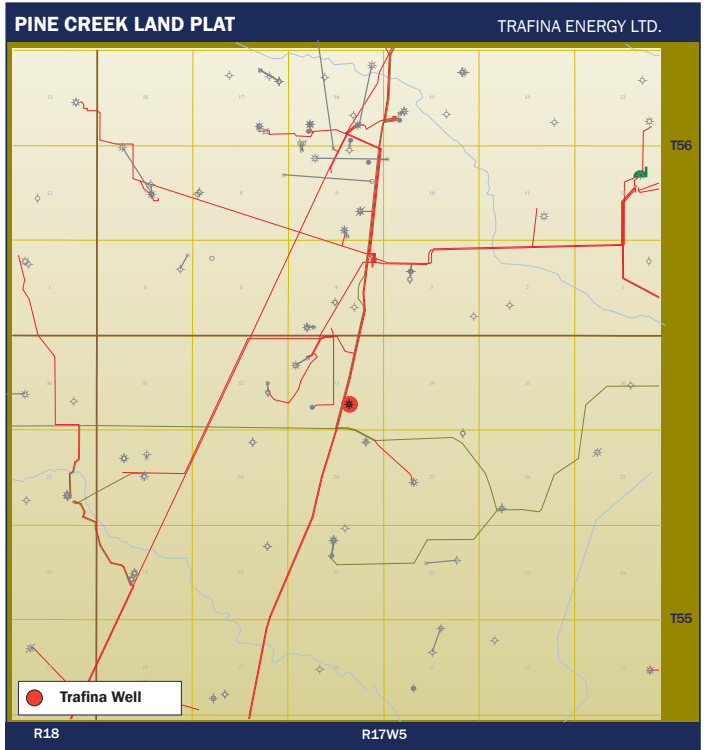
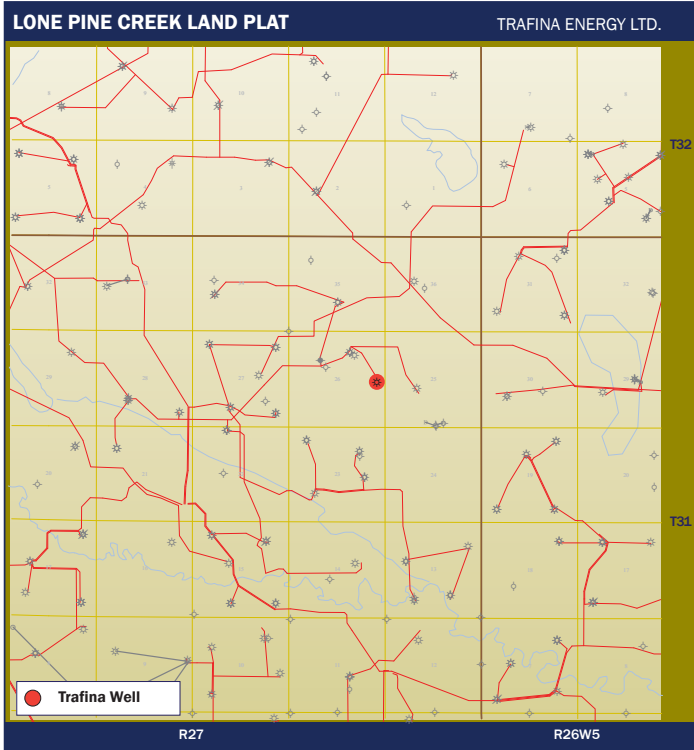

**WELL SUMMARY**

Well Location	Zone	WI (%)	Operator	Status	Field
100/08-26-031-27W4/00	Horseshoe Canyon	0.74%	Husky	Suspended CBM	Lone Pine Creek
100/07-33-055-17W5/02	Nordegg	29.61%	Shell	Abandoned Gas	Pine Creek
100/06-18-055-26W4/02	Ellerslie	37.50%	Signalta	Abandoned Oil	Riviere
100/06-10-028-8W4/00	Ellerslie	15.00%	Avenex	Abandoned Oil	Heathdale

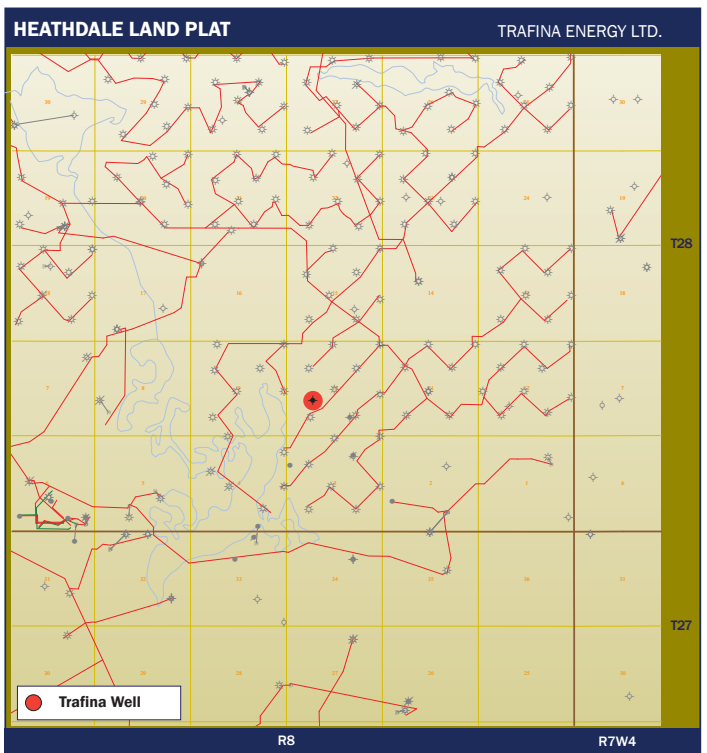
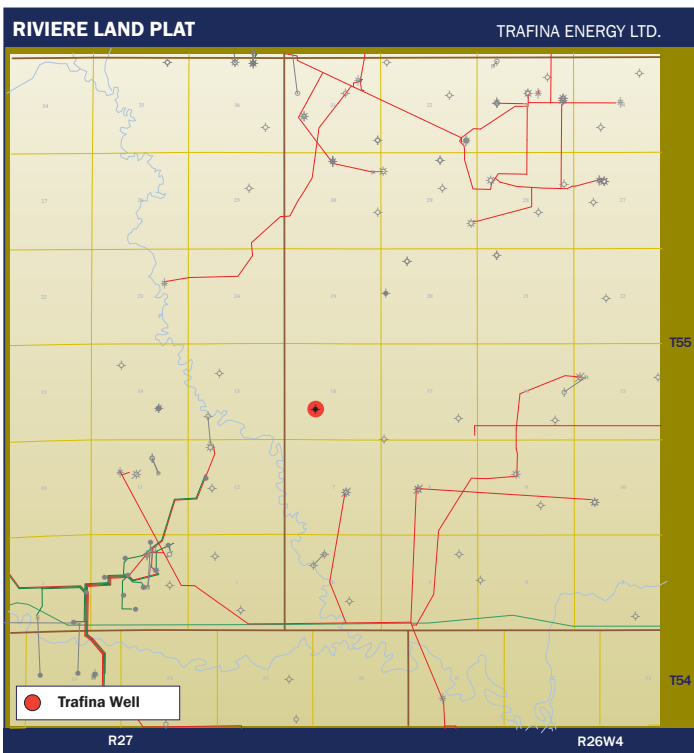

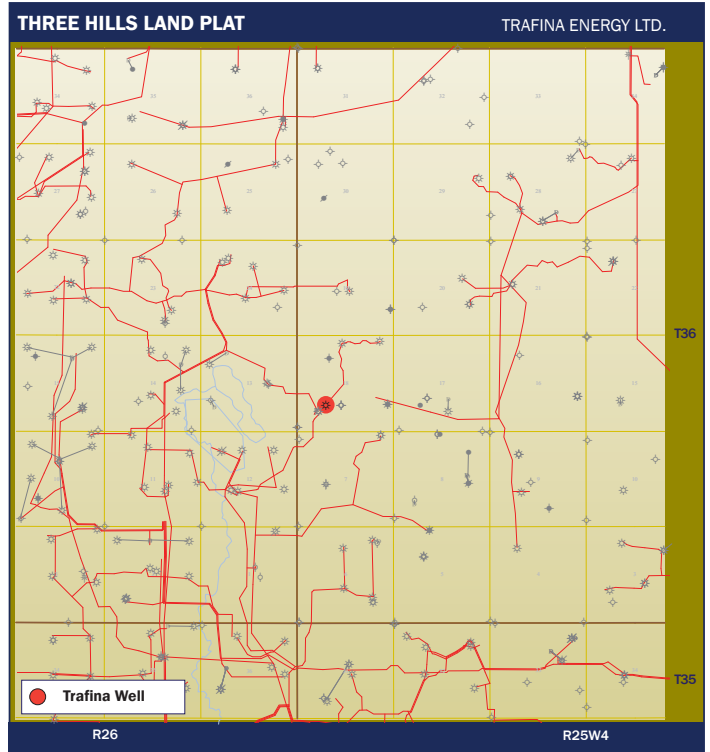
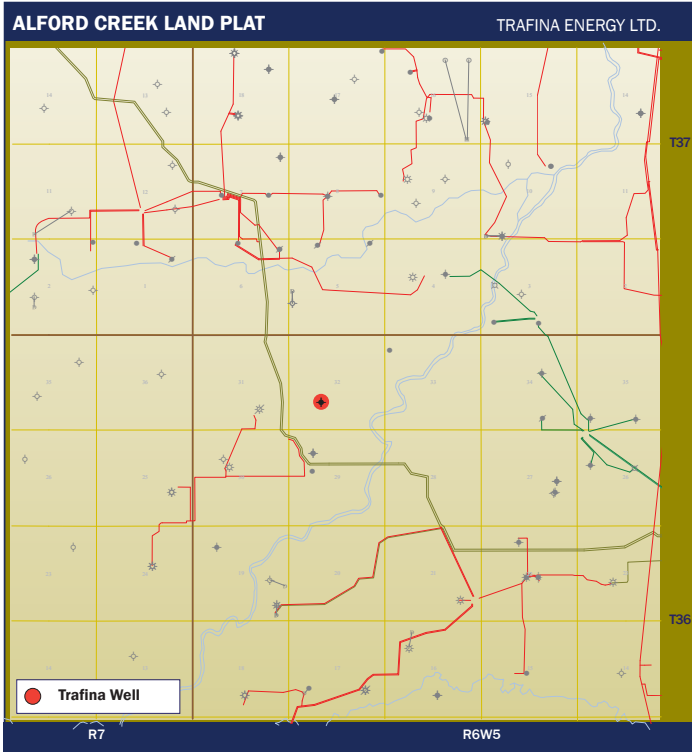

**WELL SUMMARY**

Well Location	Zone	WI (%)	Operator	Status	Field
100/06-32-036-06W5/00	Ellerslie	2.25%	Hunt	Abandoned Oil	Alford Creek
100/06-018-036-25W4/03	Pekisko	1.13%	Avenex	Abandoned	Three Hills Creek
100/08-01-118-08W6/00	Keg River	7.50%	Apache	Abandoned Oil	Shekillie
100/09-06-118-08W6/00	Chinchaga	5.00%	Apache	Abandoned	Shekillie
100/04-17-055-04W5/00	Exshaw	4.50%	Avenex	Abandoned	Alexis

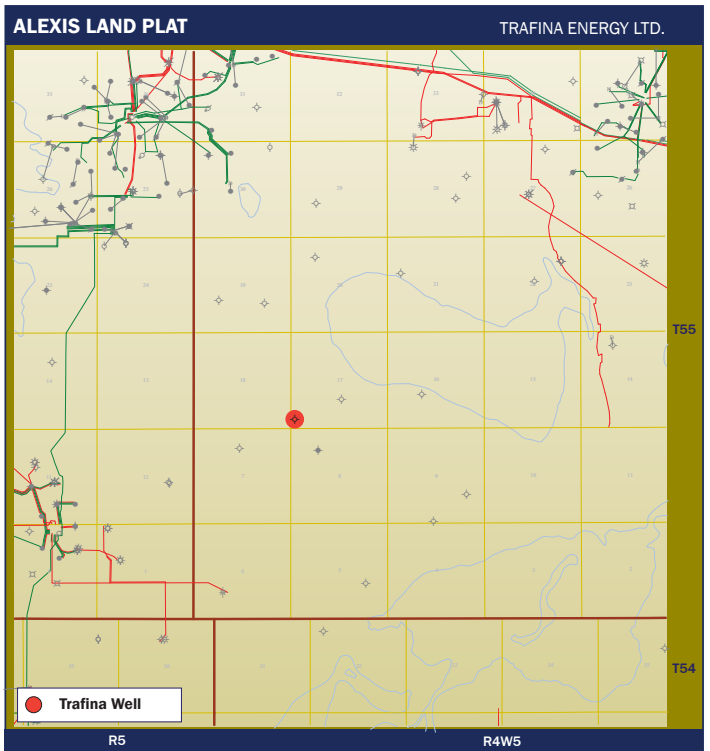
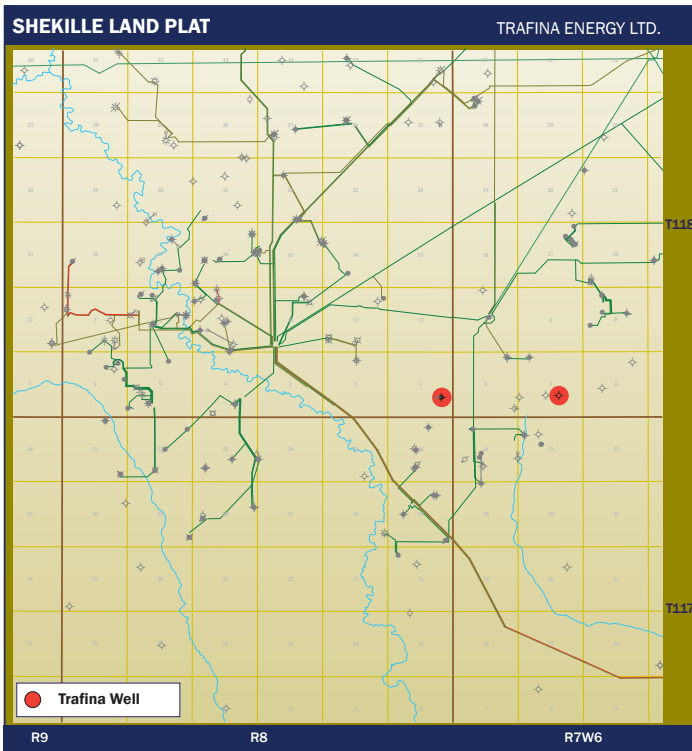

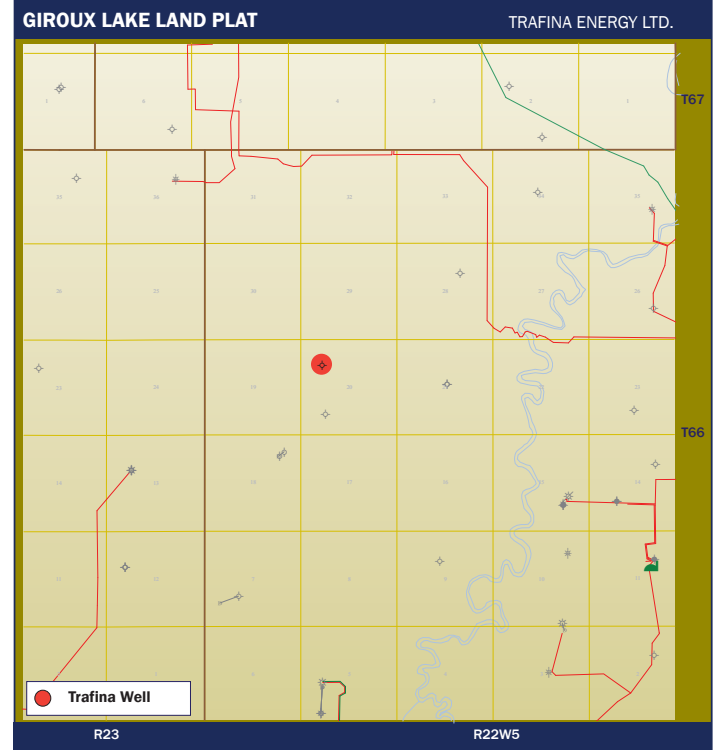
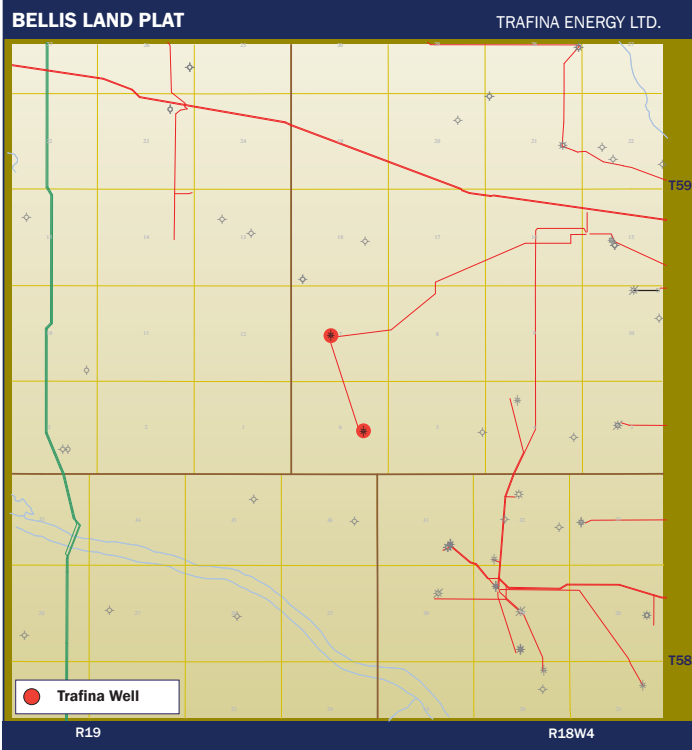

**WELL SUMMARY**

Well Location	Zone	WI (%)	Operator	Status	Field
100/06-07-059-18W4/00	Mannville	5.25%	Avenex	Abandoned Gas	Bellis
100/07-06-059-18W4/00	Mannville	5.25%	Avenex	Abandoned Gas	Bellis
100/12-20-066-22W5/00	Mannville	2.50%	Samedan	Abandoned	Giroux Lake
100/14-11-072-08W6/02	Halfway	15.00%	Encana	Abandoned Oil	Grand Prairie
100/08-27-073-07W6/00	Fernie	15.00%	Avenex	Abandoned	Grand Prairie
100/03-32-080-18W4/00	Devonian	15.00%	Avenex	Abandoned	House Mountain

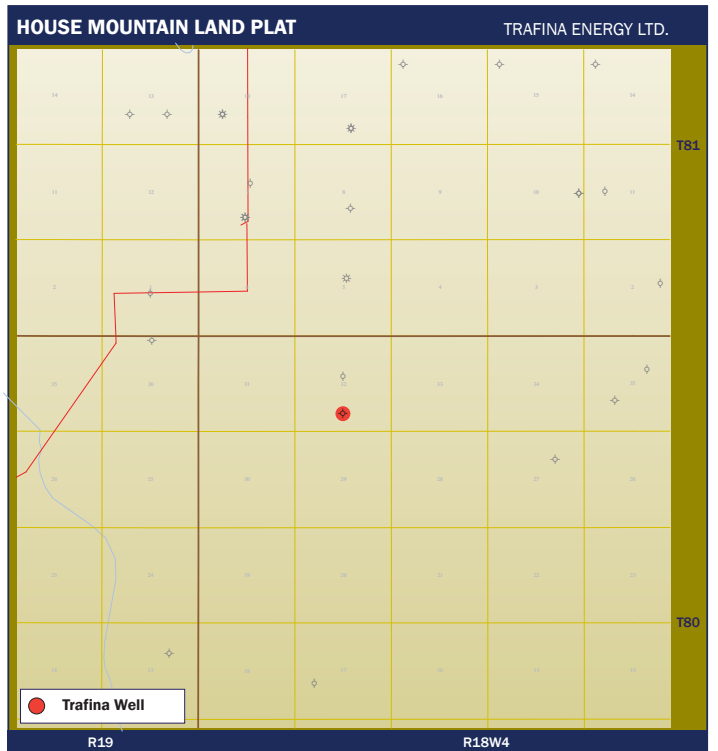
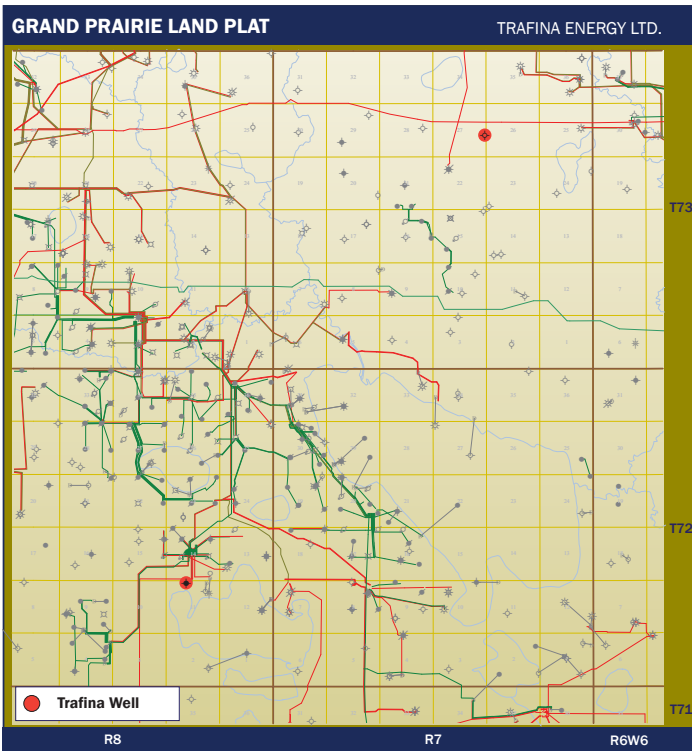

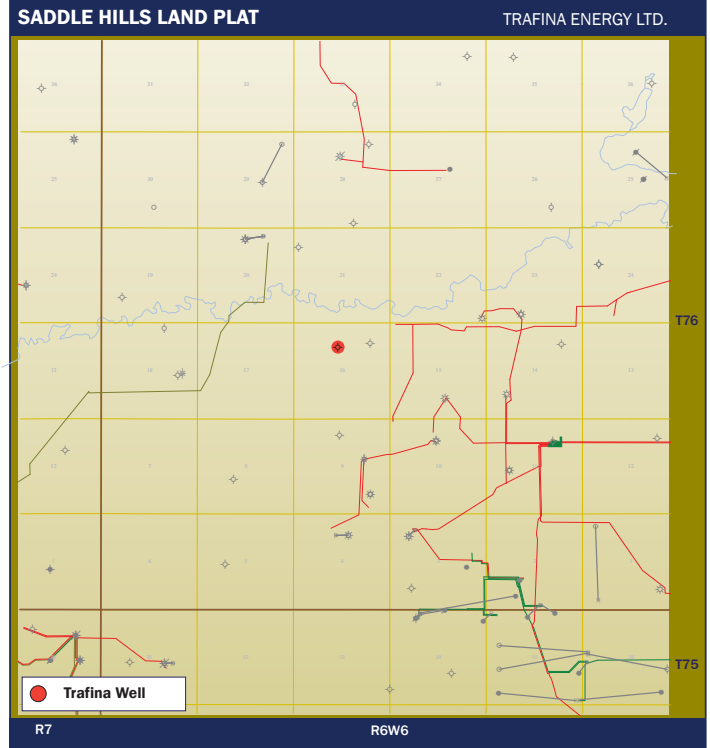
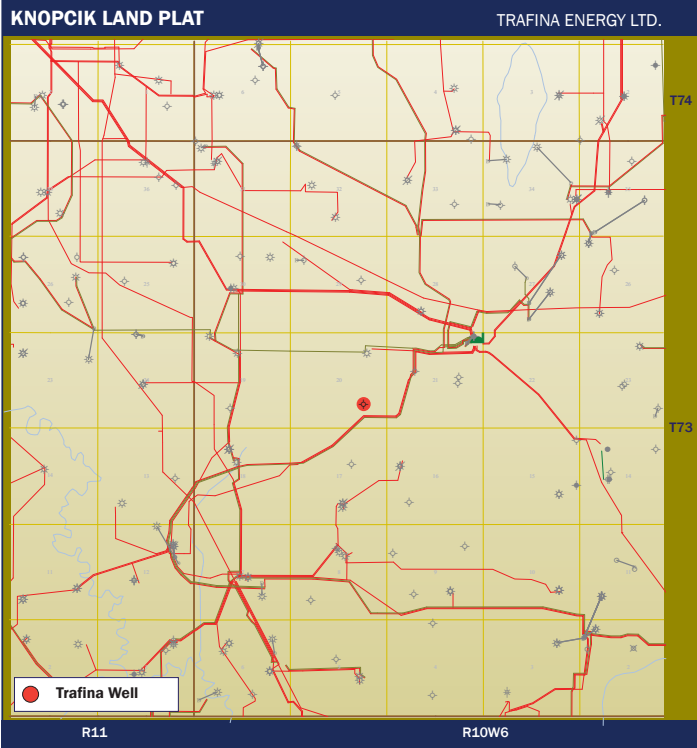

**WELL SUMMARY**

Well Location	Zone	WI (%)	Operator	Status	Field
100/08-20-073-10W6/00	Doig	23.25%	Avenex	Abandoned	Knopcik
100/11-16-076-06W6/00	Montney	3.13%	Avenex	Abandoned	Saddle Hills
100/01-19-083-09W5/00	Precambrian	15.00%	Archean	Abandoned	Utikuma Lake
100/08-35-084-10W5/00	Precambrian	15.00%	Sinopec Daylight	Abandoned	Utikuma Lake
100/01-31-081-10W5/00	Keg River	15.00%	Vermilion	Abandoned	Utikuma Lake
100/02-33-081-10W5/00	Keg River	15.00%	Vermilion	Abandoned Oil	Utikuma Lake
100/01-25-081-11W5/00	Keg River	15.00%	Husky	Abandoned Oil	Utikuma Lake

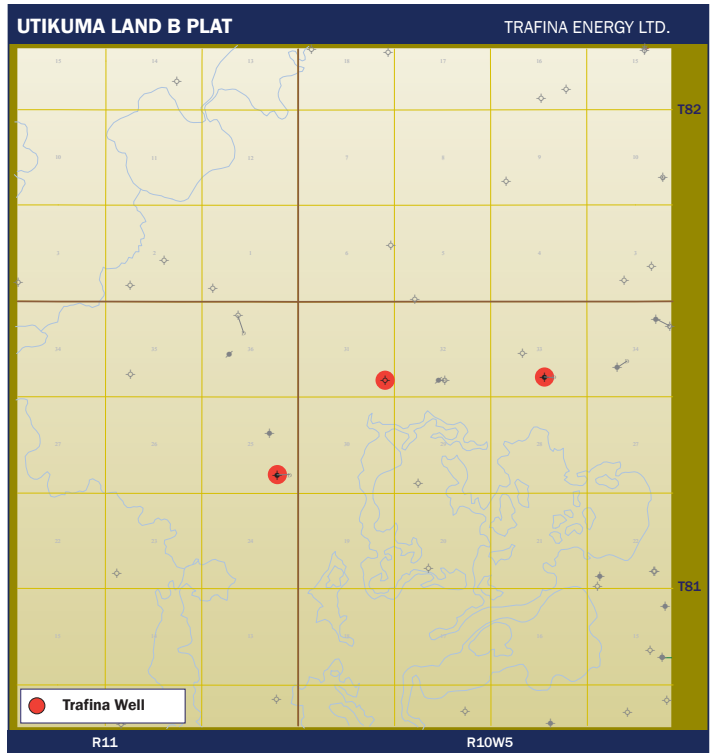
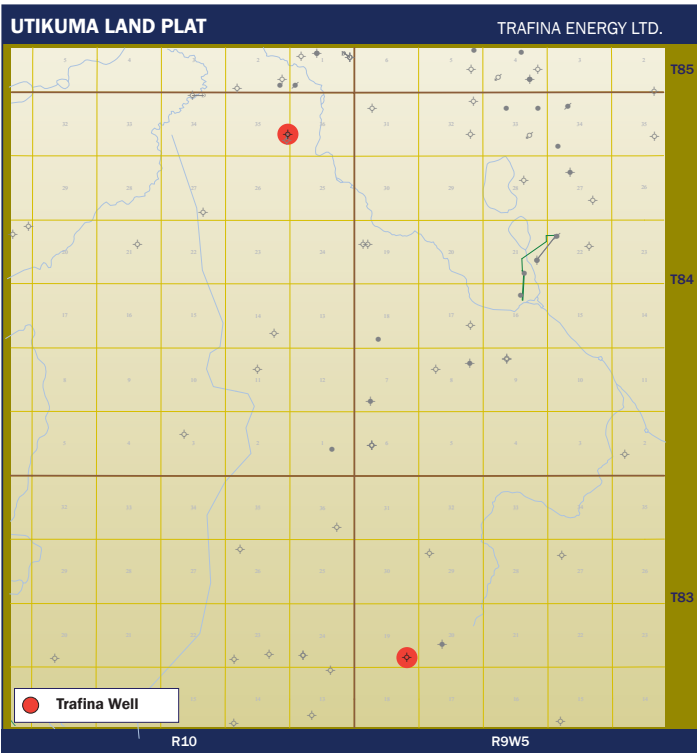



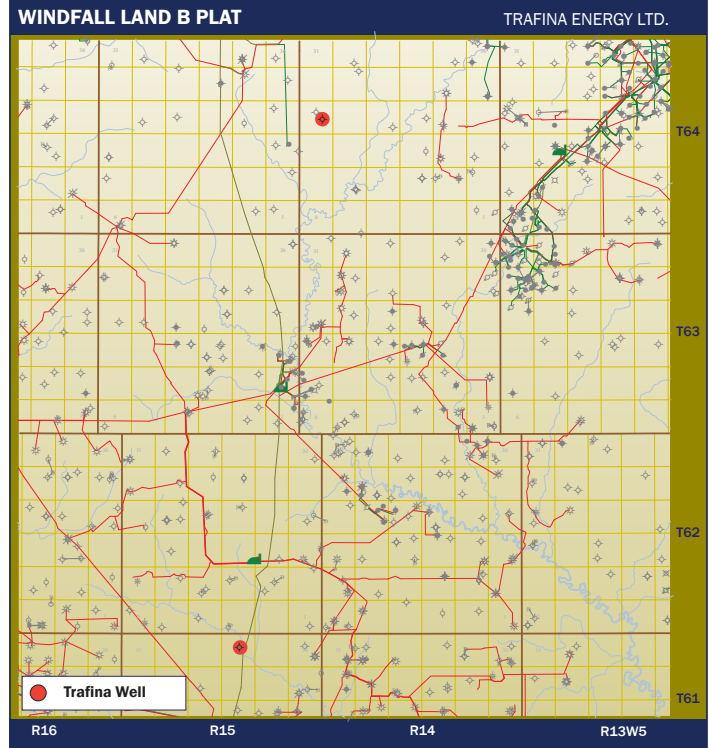

**WELL SUMMARY**

Well Location	Zone	WI (%)	Operator	Status	Field
100/01-36-063-23W5/00	Montney	5.00%	RMP	Abandoned	Waskahigan
100/07-19-064-14W5/00	Shunda	11.25%	Avenex	Abandoned	WindFall
100/10-34-061-15W5/00	Precambrian	7.50%	Suncor	Abandoned	WindFall
100/10-21-066-15W5/00	Ireton	2.31%	Taqa	Abandoned	Meekwap
102/04-28-066-15W5/00	Ireton	1.03%	Taqa	Abandoned	Meekwap
100/08-21-066-15W5/00	Nisku	1.88%	Bellatrix	Abandoned	Meekwap
100/10-25-020-24W4/00	Shunda	15.00%	Avenex	Abandoned	Farrow

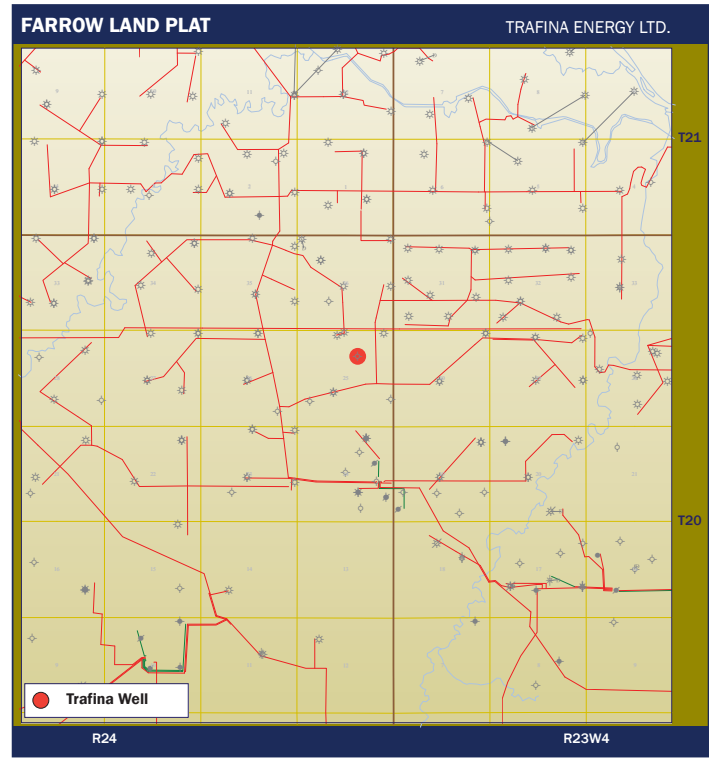
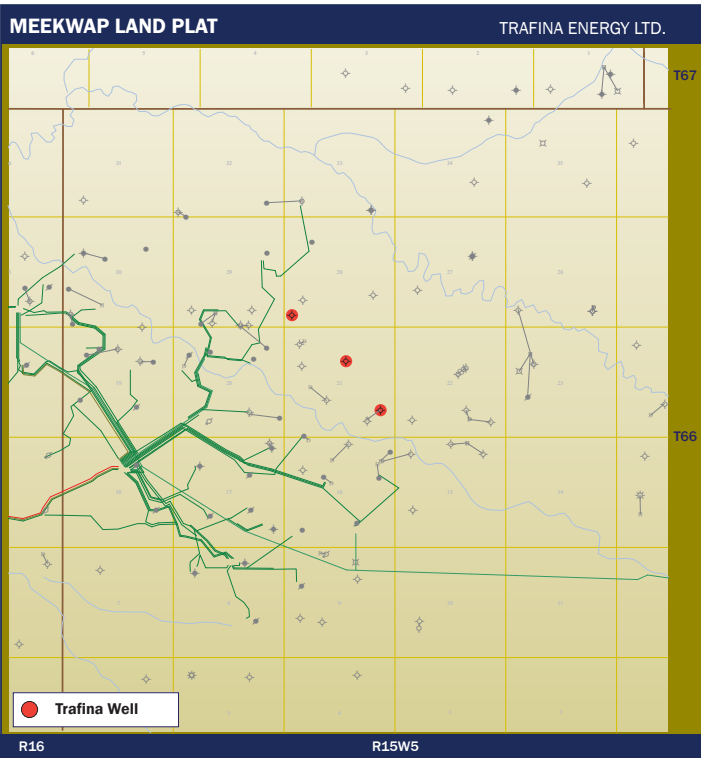

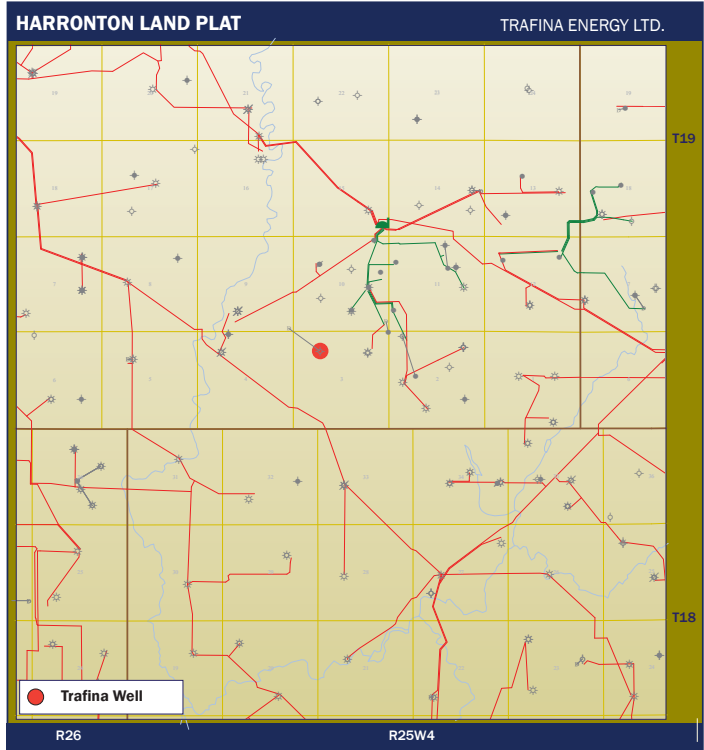
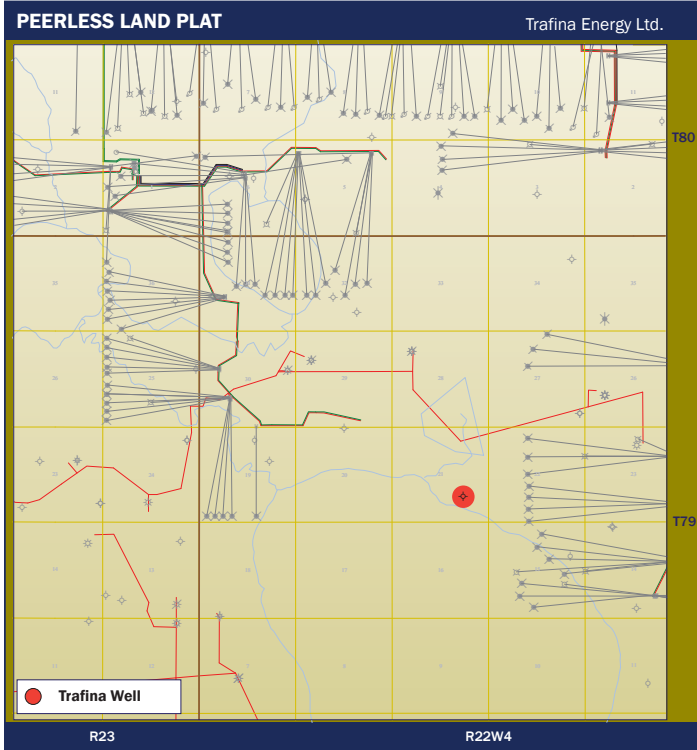

**WELL SUMMARY**

Well Location	Zone	WI (%)	Operator	Status	Field
100/07-21-079-22W4/00	Nisku	2.31%	CNRL	Abandoned	Peerless
100/14-03-019-25W4/00	Shunda	25.00%	Vermilion	Abandoned	Herronton
102/10-25-075-21W4/00	Nisku	50.00%	Husky	Standing	Twin Lake
102/10-23-070-12W5/00	Beaverhill Lake	50.00%	Unknown	Abandoned Oil	Swan Hills

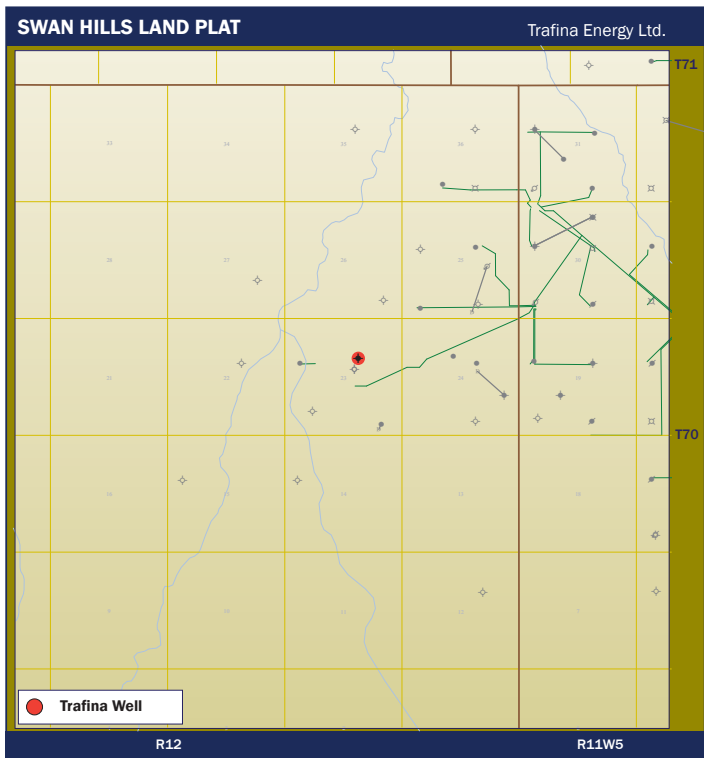
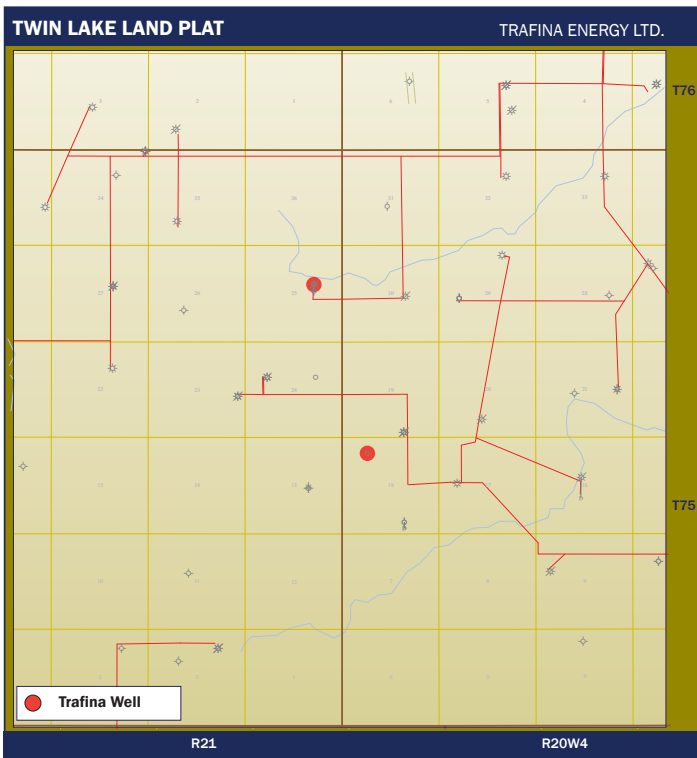

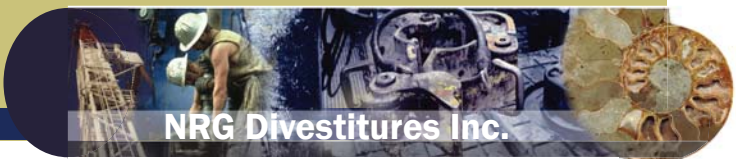

**ESTIMATED SITE RESTORATION COSTS**

Well Location	Well	Gross		Trafina W.I.	Net	
		Well Abandonment	Site Reclamation		Well Abandonment	Site Reclamation
Jenner	00/12-21-022-05W4/0	30000	20000	10.00%	3,000	2,000
Jenner	00/06-28-022-05W4	30000	20000	10.00%	3,000	2,000
Jenner	04/06-28-022-02W4/0	30000	20000	10.00%	3,000	2,000
Bittern Lake	100/06-22-046-23W4/00		0	50.00%	-	-
Bittern Lake	100/07-22-046-23W4/00		0	50.00%	-	-
Bittern Lake	100/01-34-046-23W4/00	22000	0000	50.00%	11,000	10,000
Bittern Lake	100/06-34-046-23W4/00	7200	20000	50.00%	3,600	10,000
Bittern Lake	100/01-16-047-23W4/00	22000	20000	50.00%	11,000	10,000
Bittern Lake	100/07-16-047-23W4/00	7200	20000	50.00%	3,600	10,000
Bittern Lake	100/07-12-047-23W4/00	7200	20000	50.00%	3,600	10,000
Bittern Lake	100/12-12-047-23W4/00	22000	20000	50.00%	11,000	10,000
Swan Hills	102/10-23-070-12W5/00		20000	50.00%	-	10,000
Wizard Lake / Leduc Woodbend	100/07-20-048-24W4/00	15000	20000	50.00%	7,500	10,000
Wizard Lake / Leduc Woodbend	100/13-20-048-24W4/00	7200	20000	50.00%	3,600	10,000
Wizard Lake / Leduc Woodbend	100/07-32-048-24W4/00	16000	20000	50.00%	8,000	10,000
Wizard Lake / Leduc Woodbend	100/07-24-048-24W4/00	16000	20000	50.00%	8,000	10,000
Wizard Lake / Leduc Woodbend	100/07-30-048-24W4/00		0	50.00%	-	-
Wizard Lake / Leduc Woodbend	100/13-30-048-24W4/00	2000	0	50.00%	-	10,000
Wizard Lake / Leduc Woodbend	100/09-10-049-26W4/00	7200	2000	50.00%	3,600	10,000
Wizard Lake / Leduc Woodbend	102/09-32-048-27W4/00		20000	50.00%	-	10,000
Wizard Lake / Leduc Woodbend	100/08-14-048-25W4/00		0	50.00%	-	-
Provost	100/06-07-041-07W4/00	0	20000	14.25%	-	2,850
Provost	100/11-18-041-07W4/00	0	20000	14.25%	-	2,850
Chigwell	100/14-18-041-24W4/00	7200	20000	11.67%	840	2,333
Provost	100/12-15-037-04W4/00	0	13200	1.13%	-	149
Provost	100/07-19-037-04W4/00	0	23200	3.30%	-	766
Provost	100/06-34-038-12W4/00	0	20000	14.25%	-	2,850
Provost	100/11-06-041-07W4/00	0	20000	14.25%	-	2,850
Provost	100/09-19-041-07W4/00	0	20000	14.25%	-	2,850
Lone Pine Creek	100/08-26-031-27W4/00	25000	20000	0.74%	185	148
Pine Creek	100/07-33-055-17W5/02	85000	20000	29.61%	25,169	5,922
Riviere	100/06-18-055-26W4/02	0	20000	37.50%	-	7,500
Heathdale	100/06-10-028-8W4/00	0	13000	15.00%	-	1,950
Alford Creek	100/06-32-036-06W5/00	0	20000	2.25%	-	450
Threehills Creek	100/06-018-036-25W4/03	0	20000	1.13%	-	225
Shekillie	100/07-05-118-07W6/00	0	20000	7.50%	-	1,500
Shekillie	100/08-01-118-08W6/00	0	20000	7.50%	-	1,500
Shekillie	100/09-06-118-08W6/00	0	20000	5.00%	-	1,000
Alexis	100/04-17-055-04W5/00	0	20000	4.50%	-	900
Bellis	100/06-07-059-18W4/00	0	20000	5.25%	-	1,050
Bellis	100/07-06-059-18W4/00	0	20000	5.25%	-	1,050
Grand Prairie	100/14-11-072-08W6/02	0	27000	15.00%	-	4,050
Grand Prairie	100/08-27-073-07W6/00	0	27000	15.00%	-	4,050
House Mountain	100/03-32-080-18W4/00	0	20000	15.00%	-	3,000
Knopcik	100/08-20-073-10W6/00	0	27000	23.25%	-	6,278
Saddle Hills	100/11-16-076-06W6/00	0	27000	3.13%	-	844
Utikuma Lake	100/01-19-083-09W5/00	0	0	15.00%	-	-
Waskahigan	100/01-36-063-23W5/00	0	24000	5.00%	-	1,199
WindFall	100/07-19-064-14W5/00	0	24000	11.25%	-	2,700
WindFall	100/10-34-061-15W5/00	0	24000	7.50%	-	1,800
Wetaskiwin	100/07-17-045-23W4/02	2000	0	1.88%	-	375
Utikuma Lake	100/08-35-084-10W5/00	0	0	15.00%	-	-
Utikuma Lake	100/01-31-081-10W5/00	0	20000	15.00%	-	3,000
Utikuma Lake	100/02-33-081-10W5/00	0	20000	15.00%	-	3,000
Utikuma Lake	100/01-25-081-11W5/00	0	20000	15.00%	-	3,000
Meekwap	100/10-21-066-15W5/00	30000	20000	2.31%	692	462
Peerless	100/07-21-079-22W4/00	0	20000	2.31%	-	462
Meekwap	102/04-28-066-15W5/00	0	0	1.03%	-	-
Meekwap	100/08-21-066-15W5/00	0	20000	1.88%	-	375
Farrow	100/10-25-020-24W4/00	0	20000	15.00%	-	3,000
Herronton	100/14-03-019-25W4/00	0	20000	25.00%	-	5,000
Twin Lake	02/10-25-075-21 W4	35000	20000	50.00%	17,500	10,000
Twin Lake	00/13-18-075-20 W4 (Only Lease Reclaim.) above well never drilled		20000	50.00%	-	10,000



**Bankers Hall, West Tower**  
1000, 888 - 3rd Street S.W.  
Calgary, Alberta T2P 5C5  
Phone: 403 444 5991  
Fax: 403 444 6699

**[www.nrgdivestitures.co](http://www.nrgdivestitures.co)**

